

PRODUCT COMPONENTS

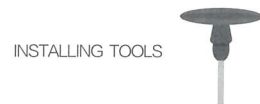

Notebook stand X1



INSTALLING TOOLS

Allen Wrench X1



IDENTIFIED PARTS

Screw X3

ASSEMBLY STEPS

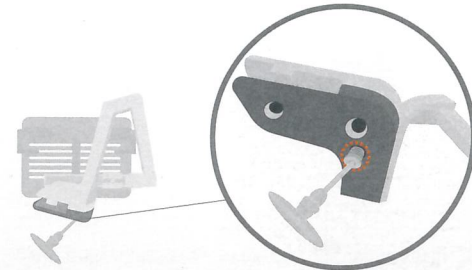

1 Screw out one point screw.

2 Take off the L-shape mounting block.

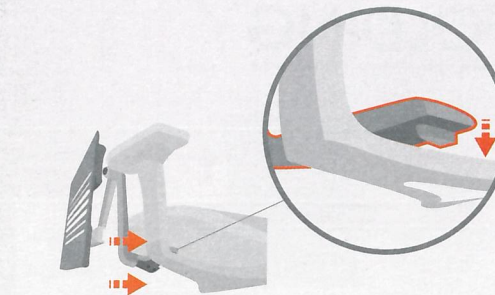
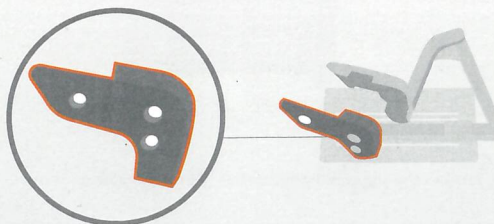

3 Place the Notebook stand main support part on chair left arm.

4 Insert the L-shape mounting block to the bottom of left arm, and then tighten 3 screws to the Notebook stand.

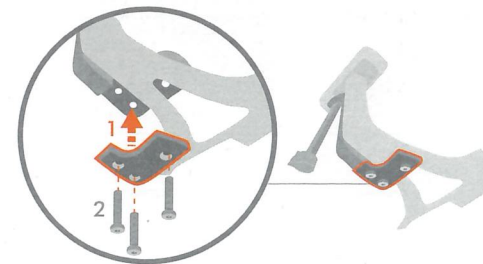

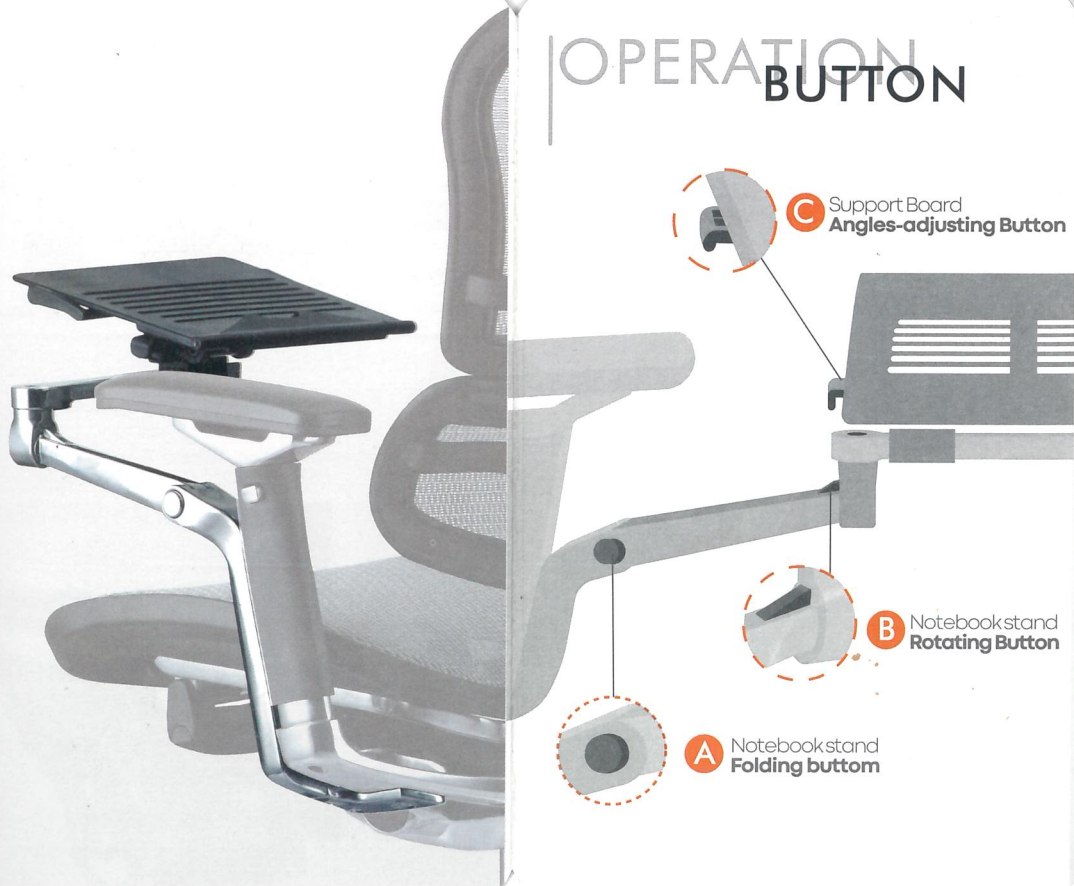

OPERATION BUTTON



C Support Board
Angles-adjusting Button



B Notebookstand
Rotating Button



A Notebookstand
Folding button

UNFOLDING

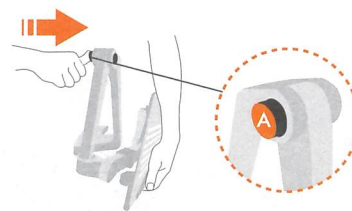

1 Press Button **A** with your right hand.

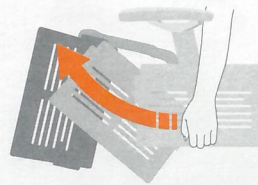

2 Rotate the support board forwards with your left hand until the click sound can be heard.

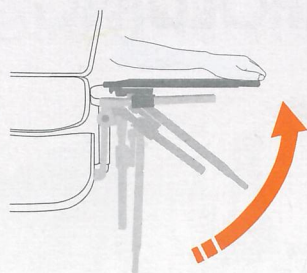

- 3 Turn up the support board by rotating it upwards to 90°.



- 4 180° adjustment support board to suit personal comfort.
- 5 Push the support board rightwards it in the most comfortable position.



- 6 Press button  and rotate the support board horizontally or upwards to comfortable position.

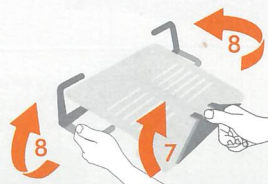

- 7 Unfold  edge holder to 90°.
- 8 Pull out two  C-shape holders and rotate to 270°.

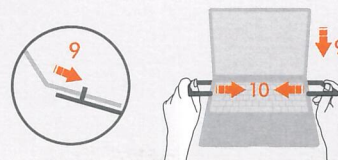

Notes



- 9 Put the laptop on the foldable Notebook stand.
- 10 Adjust two  C-shape holders to tighten the laptop.



FOLDING

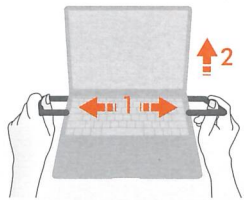

- 1 Pull out two **C-shape** holders and rotate to vertical direction with both hands.
- 2 Take the laptop out as the arrows shows in the picture.

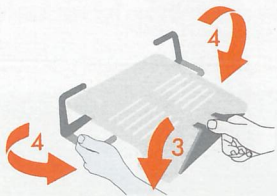

- 3 Fold up the **edge holder**.
- 4 Press two **C-shape** holders towards horizontal direction with both hands and then rotate it back to the original position.

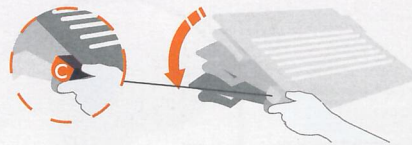

- 5 Press button **C** and adjust the support board to the horizontal position.

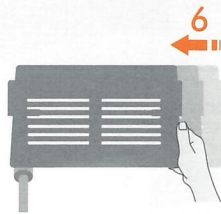

- 6 Push the support board to the leftmost position.

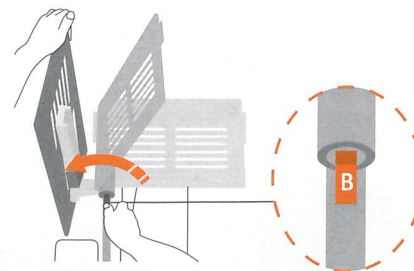

- 7 Press Button **B** and rotate the support board upwards by 90°.



- 8 Rotate the support board downwards by 180°.

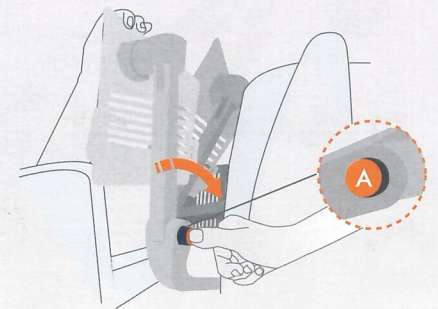

- 9 Lightly raise the support board with left hand and press button **A** with right hand. Move the notebook stand main support part backwards by 90° and then the support stand is locked automatically with a click sound.

